

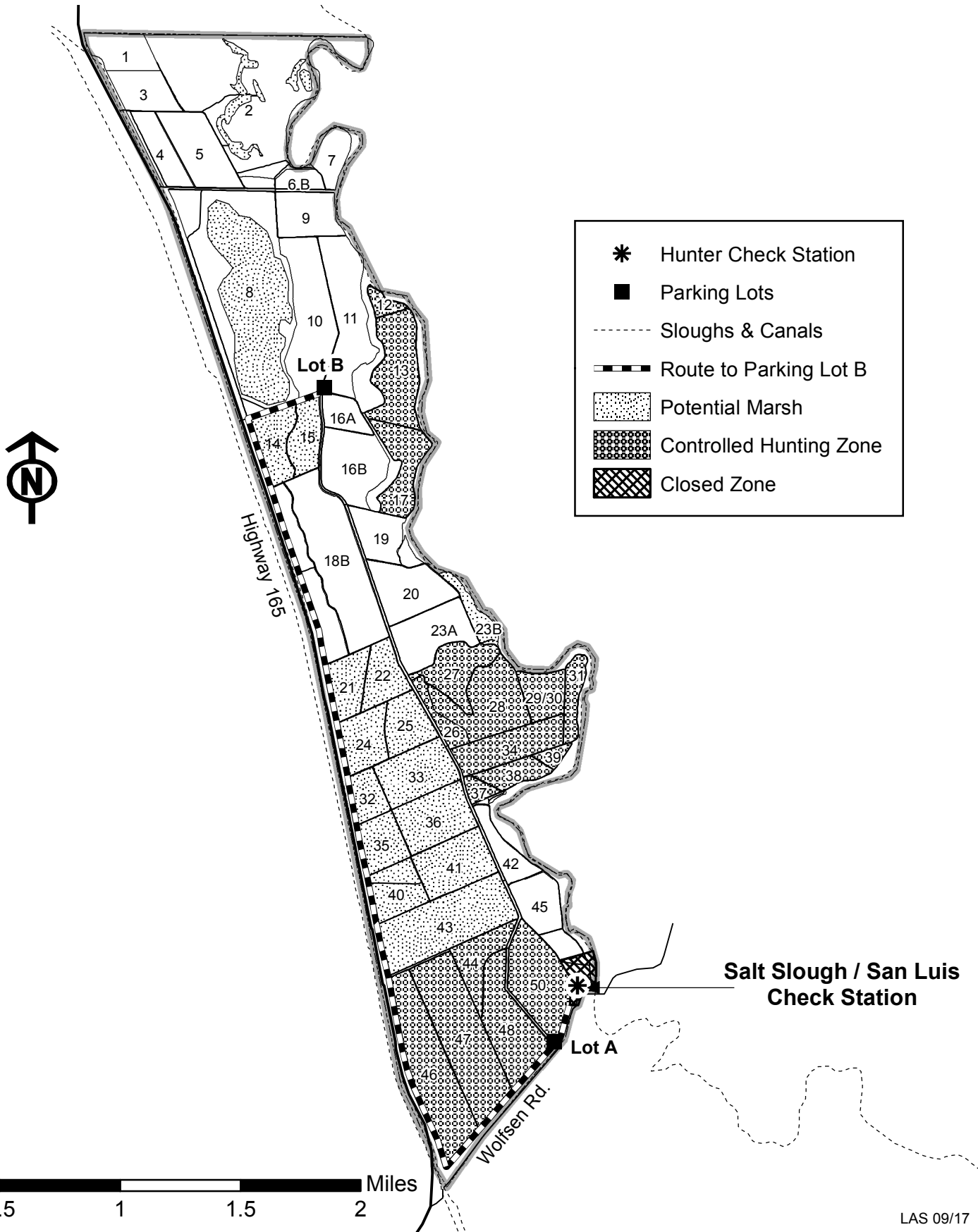

Salt Slough Unit North Grasslands Wildlife Area Waterfowl Hunt Map



STATE OF CALIFORNIA
THE RESOURCES AGENCY
DEPARTMENT OF FISH AND WILDLIFE

SALT SLOUGH UNIT
NORTH GRASSLANDS WILDLIFE AREA
INFORMATION FOR WATERFOWL AND PHEASANT HUNTERS

1. Once a hunter has left the parking lot, he may possess **no more than 25 shotgun shells.** **FEDERALLY APPROVED NONTOXIC SHOT IS REQUIRED FOR ALL HUNTING ON DEPARTMENT OF FISH AND WILDLIFE LANDS.**
2. All hunters must check in and obtain an entry permit through the check station. On waterfowl shoot days, the check station will start issuing permits two and one-half hours before shooting time.
3. Sign up for the lottery drawing will be from 6:00 P.M. to 9:00 P.M. the evening before a hunt day with the lottery drawing conducted shortly after 9:00 PM. Results will be posted outside the Salt Slough check station.
4. All hunters must check out at the check station and return all permits before leaving the wildlife area.
5. Hunters must have in their possession valid hunting licenses, stamps and area permits while on the wildlife area.
6. Hunters must park in assigned parking lots. No camping is permitted in the field.
7. No stopping to unload/ pick up gear or passengers between designated parking lots.
8. No changing of hunt assignments or issuance of permits will be made after 3:00 PM.
9. Special permits are required to hunt the assigned ponds and blind areas.
10. **Non-lead ammunition required for hunting on all CDFW wildlife areas.**