

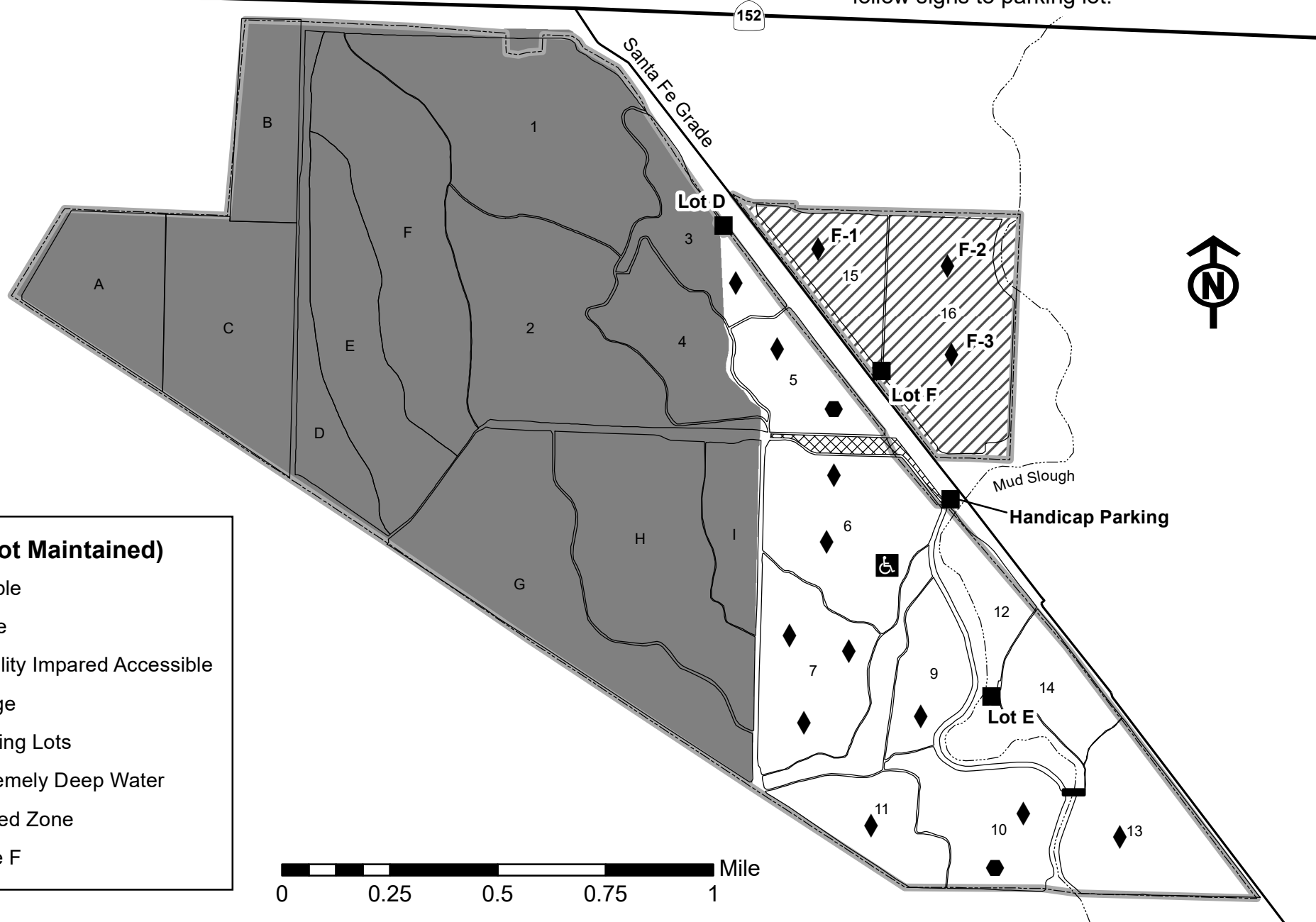

Gadwall Unit North Grasslands Wildlife Area Waterfowl Hunt Map

DIRECTIONS

One mile from Check Station to Highway 165; turn left (south) on Highway 165 for 6.5 miles to Highway 152 (signal light); turn left (east) on Highway 152 for 2.7 miles to Santa Fe Grade, turn right on Santa Fe Grade & follow signs to parking lot.



Blinds (Not Maintained)

- Double
- Triple
- Mobility Impaired Accessible
- Bridge
- Parking Lots
- Extremely Deep Water
- Closed Zone
- Zone F

STATE OF CALIFORNIA
THE RESOURCES AGENCY
DEPARTMENT OF FISH AND WILDLIFE

GADWALL UNIT
NORTH GRASSLANDS WILDLIFE AREA

INFORMATION FOR WATERFOWL AND PHEASANT HUNTERS

1. Once a hunter has left the parking lot, he may possess **no more than 25 shotgun shells.** **FEDERALLY APPROVED NONTOXIC SHOT IS REQUIRED FOR ALL HUNTING ON DEPARTMENT OF FISH AND WILDLIFE LANDS.**
2. All hunters must check in through the Salt Slough check station located on Wolfsen Road. The check station will start issuing permits two and one-half hours before shooting time.
3. Sign up for the lottery drawing will be from 6:00 P.M. to 9:00 P.M. the evening before a hunt day with the lottery drawing conducted shortly after 9:00 PM. Results will be posted outside the Salt Slough check station.
4. All hunters must check out at the Salt Slough check station or return permits at the drop box before leaving the wildlife area.
5. Hunters must have in possession valid hunting licenses, stamps and area permits while on the wildlife area.
6. Hunters must park in assigned parking lots. No camping is permitted in the field.
7. Non-assigned blinds are present on the area. Condition of individual blinds may vary.
8. No permits will be issued or hunt assignments changed after 3:00 PM
9. **BEWARE! Rattlesnakes are present on the area.**