



Redwood Creek, Humboldt County  
(Field Note)

*Bailey*  
*Em*

SN 90469

Tributary to: Pacific Ocean

Date of Survey: October 12 and 14, 1982

Purpose of Survey: Adult spring-run steelhead inventory.

Location: From Stover Creek to Emerald Creek

Method of Survey: Visual observation by diving

Equipment Used: Mask and snorkel

Surveyors: Dave Anderson, Jim Harrington, Joe McKeon (R.N.P.) and Mary McClain.

Observations: A total of 14 stream miles were walked. One SH/RT approximately 12-14" long and two adult steelhead were observed. All three fish were in good condition and light in color.

Temperatures °F

<u>Location</u>	<u>Date</u>	<u>Time</u>	<u>Air</u>	<u>Water</u>
Near Lacks Creek	10/12	1000	51	56
Garrett Creek	10/12	1100	65	55
Near Garrett Creek	10/12	1100	65	57
Panther	10/12	1300	--	57
Upstream of Coyote Creek	10/12	1545	63	60
Coyote Creek	10/12	1545	63	56
Downstream of Coyote Creek	10/14	0900	53	56
1 mi. upstream of Bridge Creek	10/14	1200	61	57
Pool near Bridge Creek	10/14	1400	64	57
Emerald Creek	10/14	1500	61	59

See attached map for location of following descriptions:

1. One 12-14" SH/RT in 5' deep pool.
2. One 16-18" steelhead in run.
3. One 18" steelhead in 10' deep pool.

Written by: Mary McClain  
Seasonal Aid

10/16

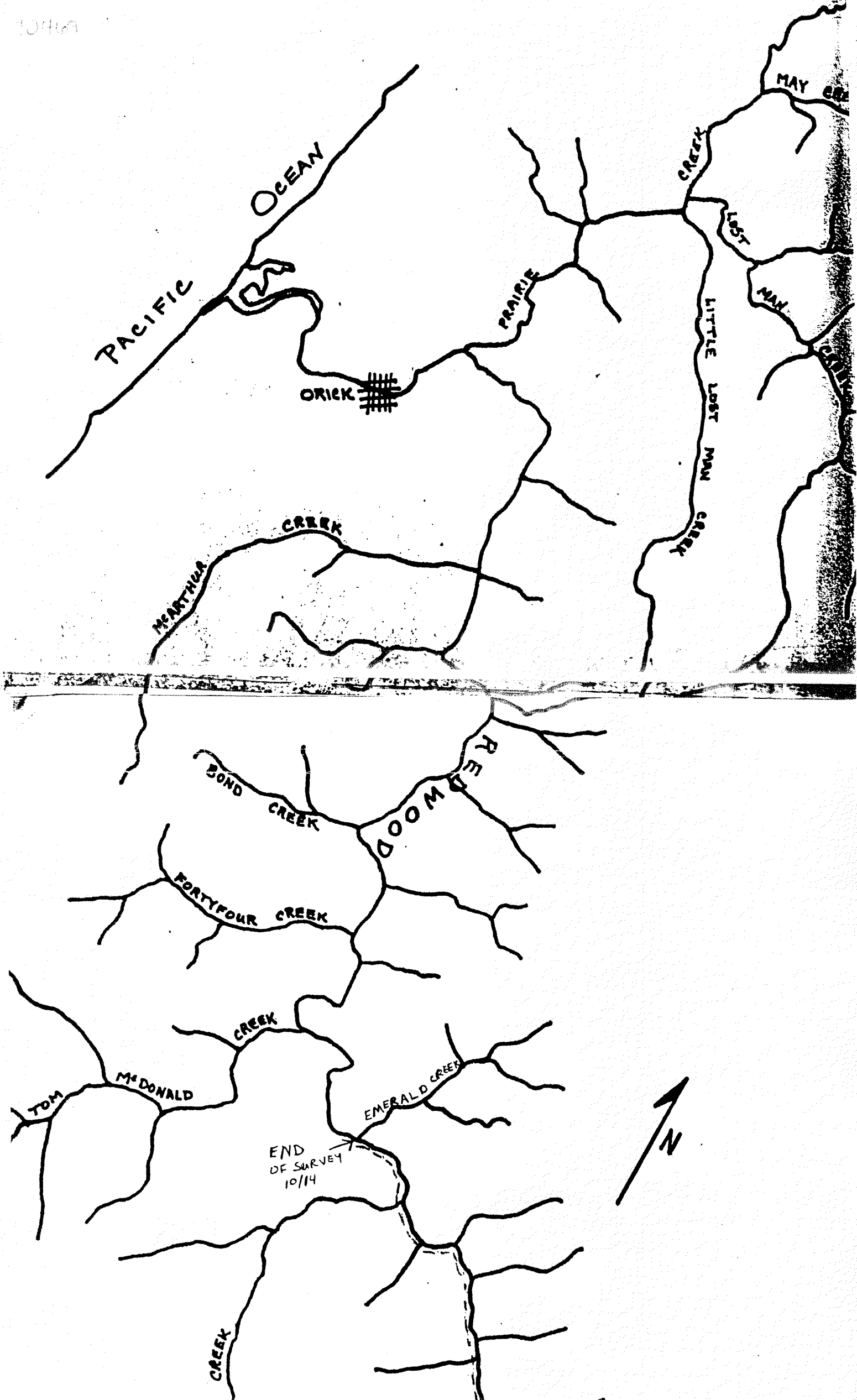

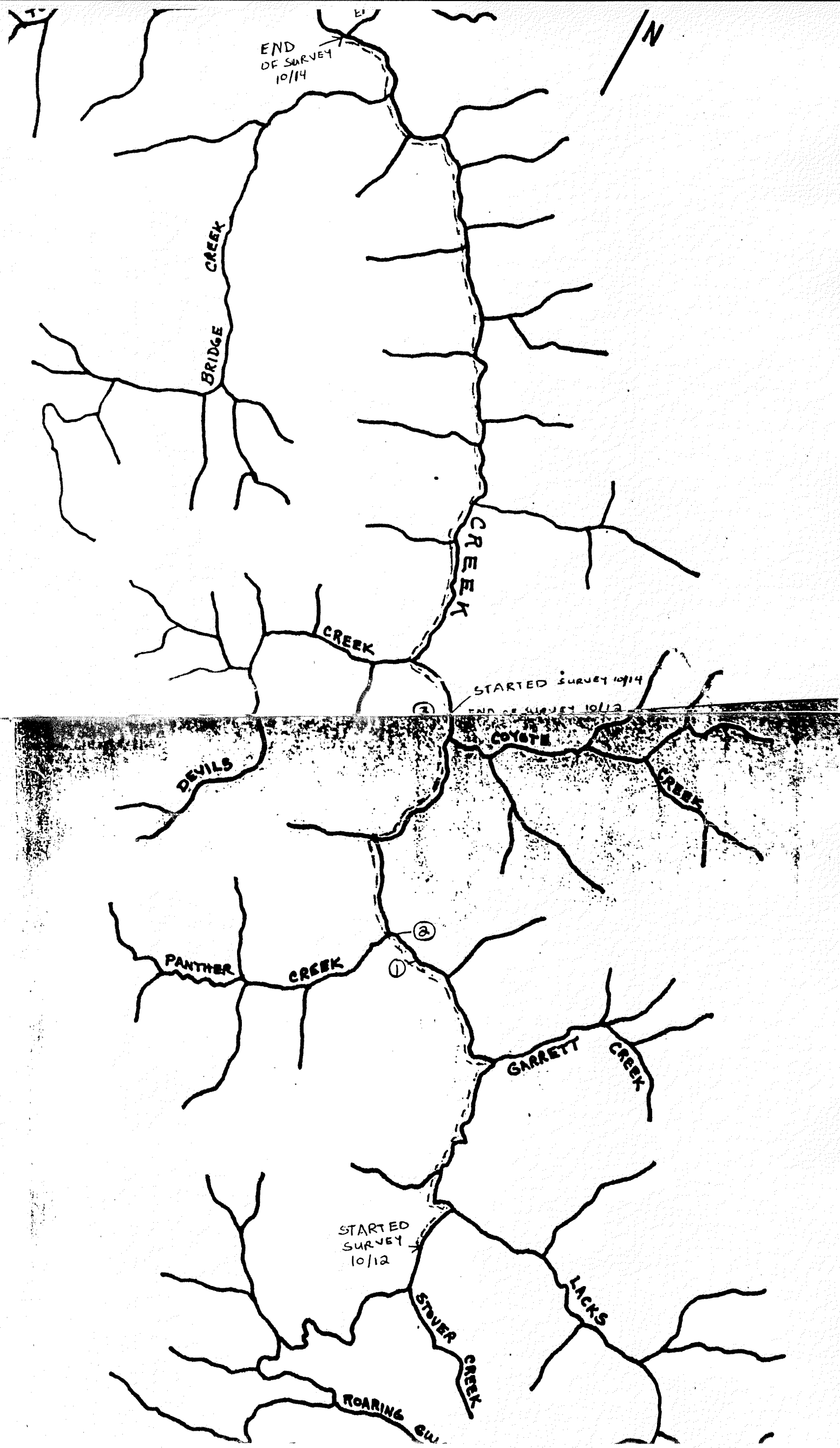

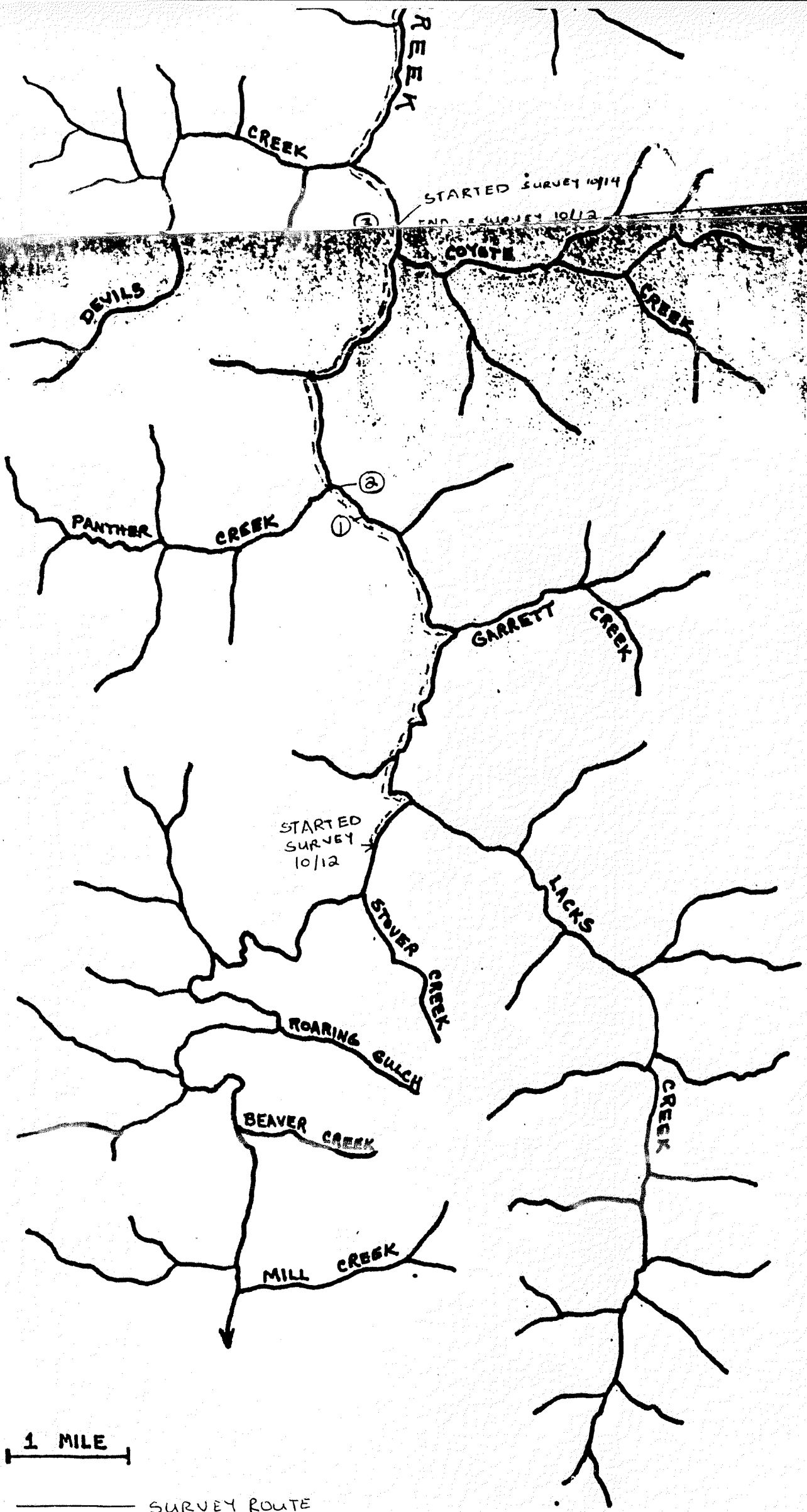

1 MILE

--- SURVEY ROUTE