

May 29, 1996

Sotoyome-Santa Rosa Resource Conservation District

Preliminary
STREAM INVENTORY REPORT SUMMARY
Sullivan Creek

INTRODUCTION

The following report was completed by Colin Close, Project Coordinator for the Sotoyome-Santa Rosa Resource Conservation District (RCD). Report format and text are based on a report template provided by the California Department of Fish and Game, Inland Fisheries Division (CDFG).

The Northwest Emergency Assistance Program, disaster relief for commercial salmon fishers, provided funding for the stream inventory and associated report. The project was sponsored and administered by the RCD. Technical oversight and guidance were provided by CDFG.

Fuller Creek watershed consists the main stem of Fuller Creek and its significant tributaries: Boyd Creek; west fork Fuller; Sullivan Creek; North Fork Fuller Creek main stem and its tributaries (A and B); and South Fork Fuller Creek and its tributaries (Elk Creek and southeast fork).

A stream inventory was conducted during November 3 - November 7, 1995 on Sullivan Creek to assess habitat conditions for anadromous salmonids. Inventories were conducted on the other tributaries to Fuller Creek. For further details regarding these water courses, please refer to the respective Stream Inventory Report Summary for each of the following: Fuller Creek, North Fork Fuller Creek, and South Fork Fuller Creek.

The objective of the habitat inventory was to document the habitat available to anadromous salmonids in Sullivan Creek. After analysis of the information and data gathered, stream restoration and enhancement recommendations are presented.

WATERSHED OVERVIEW

Sullivan Creek is tributary to Fuller Creek, tributary to the Wheatfield Fork of the Gualala River, located in Sonoma County, California (Figure 1). The legal description at the confluence with the Fuller Creek is T10N R13W S29. Its location is 38°41'25" N. latitude and 123°19'42" W. longitude. Sullivan Creek is a first order stream and has approximately 1.5 mile of blue line stream, according to the USGS Annapolis 7.5 minute quadrangle. Sullivan Creek drains a basin of approximately 5 square miles. Summer base flow is approximately 0.28 cubic feet per second (cfs) at the mouth. Elevations range from about 180 feet at the mouth of the creek to 800

FULLER CREEK
8 N. R. 13 W. SECT. 32.

SCALE 1 24000

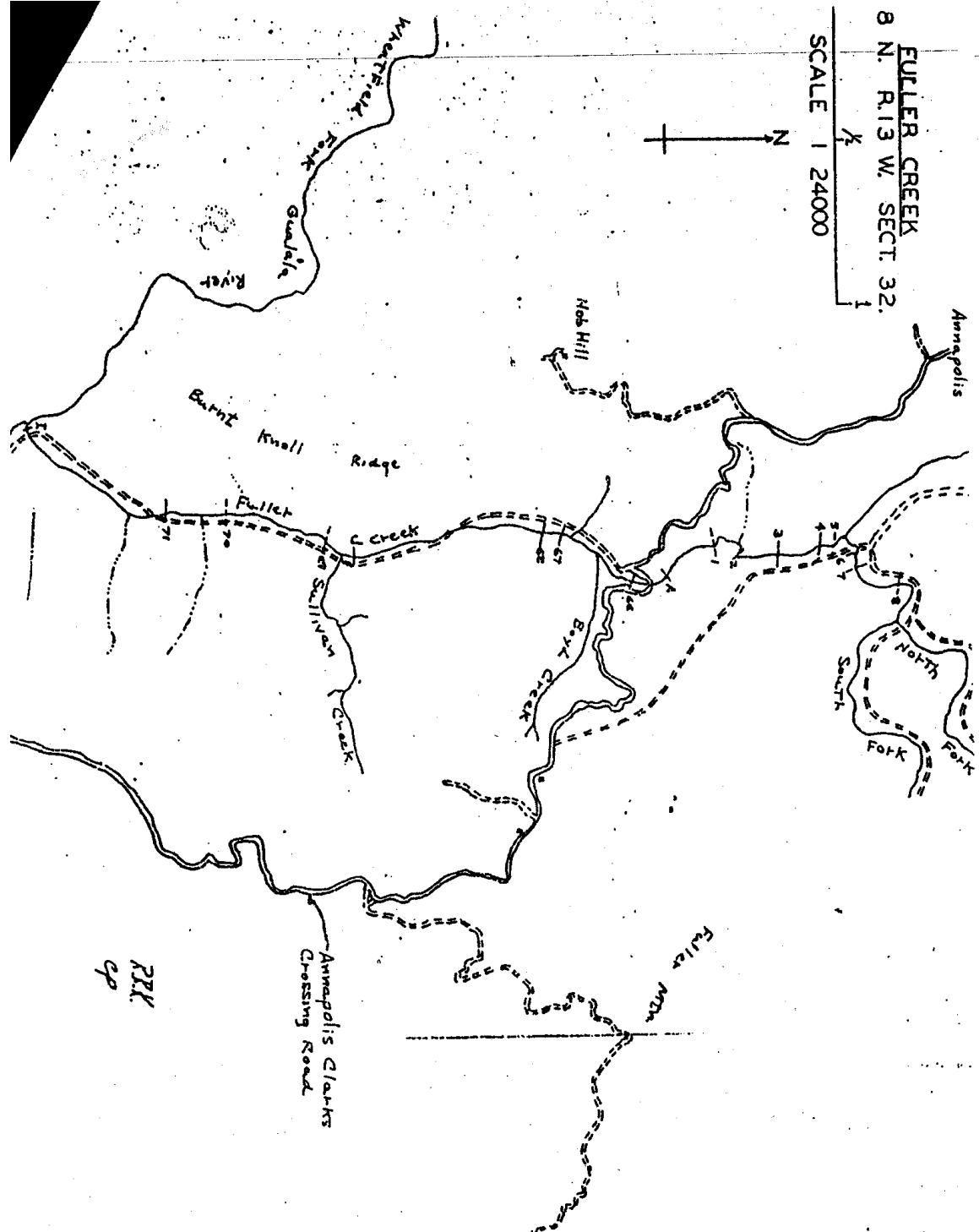
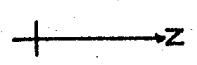

R.R.
op